

# MİMARİ KATALOG

## ARCHITECTURAL CATALOGUE

Aluminyum Kapı Pencere ve Giydirme Cephe Sistemleri  
Aluminium Window Doors and Facade Systems



Rescara Sistem  
Profil Detayları

Rescara System  
Profile Details



ENERJİ TETA

# RESCARA SİSTEM

## RESCARA SYSTEM

Aluminyum Kapı Pencere ve Giydirme Cephe Sistemleri  
Aluminium Window Doors and Facade Systems

11



12

13

14

15

16

17

18

19

20



KOD / CODE	AĞIRLIK (kg/m) / WEIGHT	Jxx cm <sup>4</sup>	Jyy cm <sup>4</sup>	L m
MST94 F 01	1,793	14,040	39,560	6
MST94 F 02	2,143	65,367	16,283	6

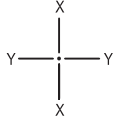

MST94 F 01

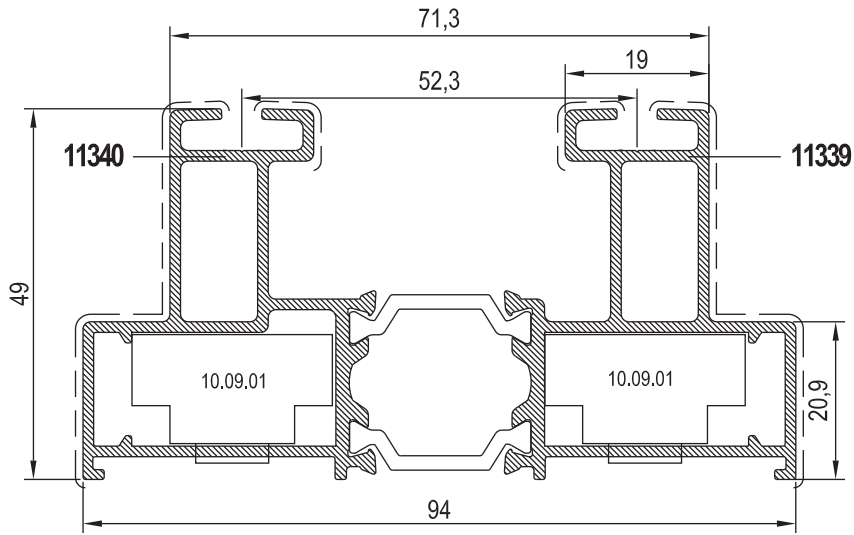

MST94 F 02

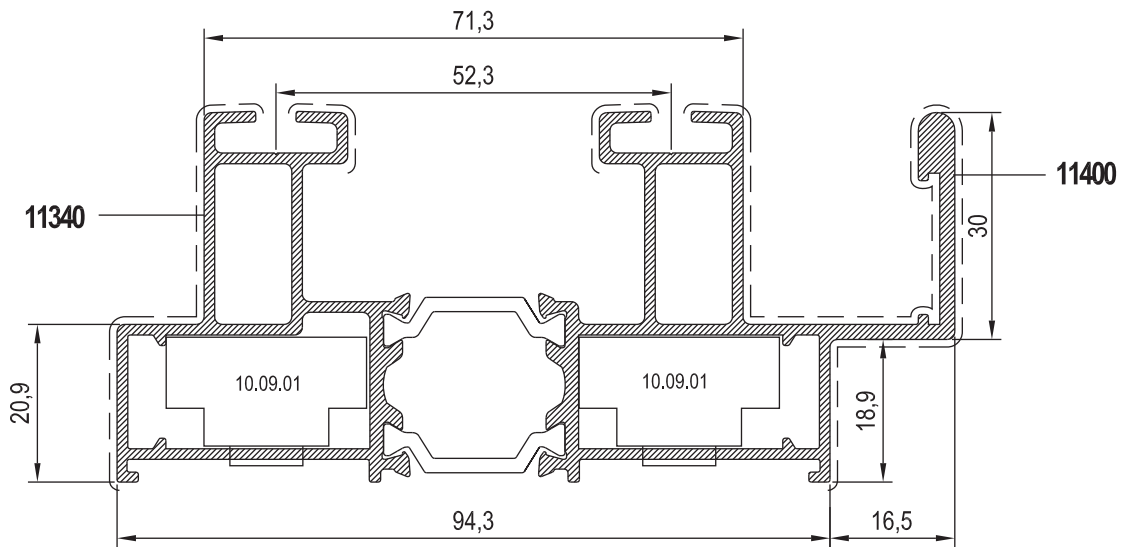



KOD / CODE	AĞIRLIK (kg/m) / WEIGHT	Jxx cm <sup>4</sup>	Jyy cm <sup>4</sup>	L m
MST94 V 01	1,812	14,053	47,859	6

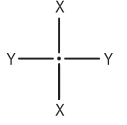

MST94 V 01

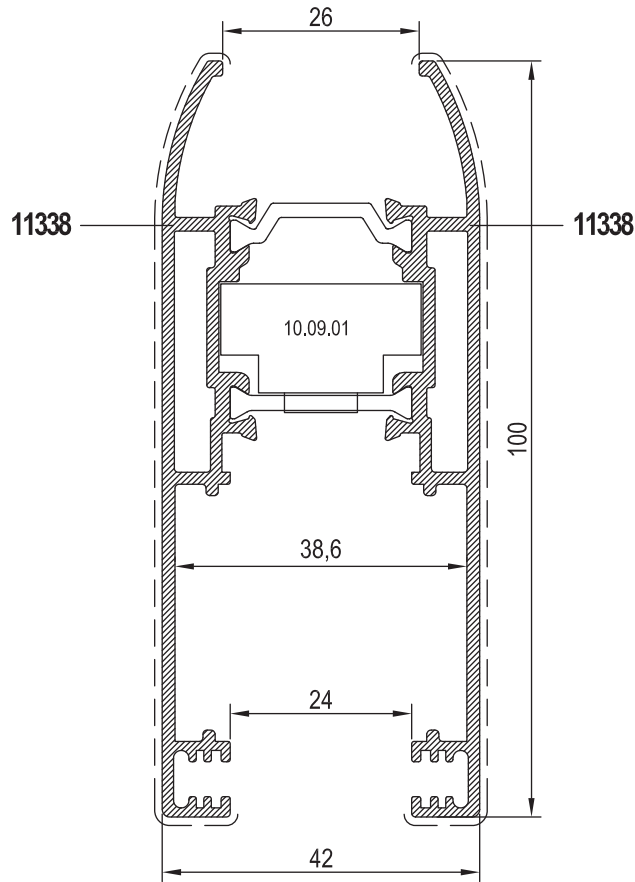



KOD / CODE	AĞIRLIK (kg/m) / WEIGHT	Jxx cm <sup>4</sup>	Jyy cm <sup>4</sup>	L m
MST94 A 01	0,472	3,087	4,863	6
MS94 A 02	0,692	11,417	2,305	6

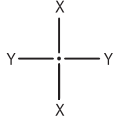

11

12

13

14

15

16

17

18

19

20

MST94 A 01

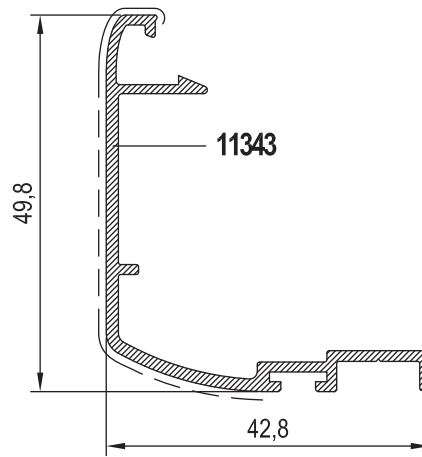

MS94 A 02

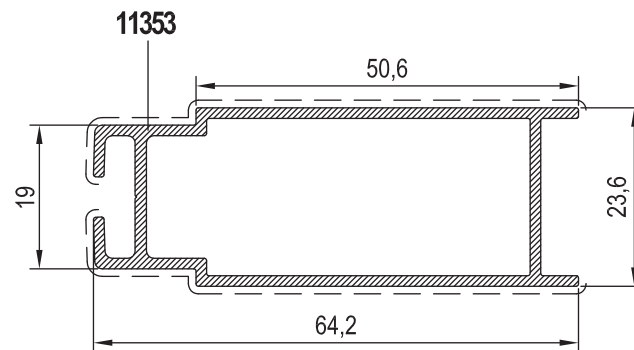



11

12

13

14

15

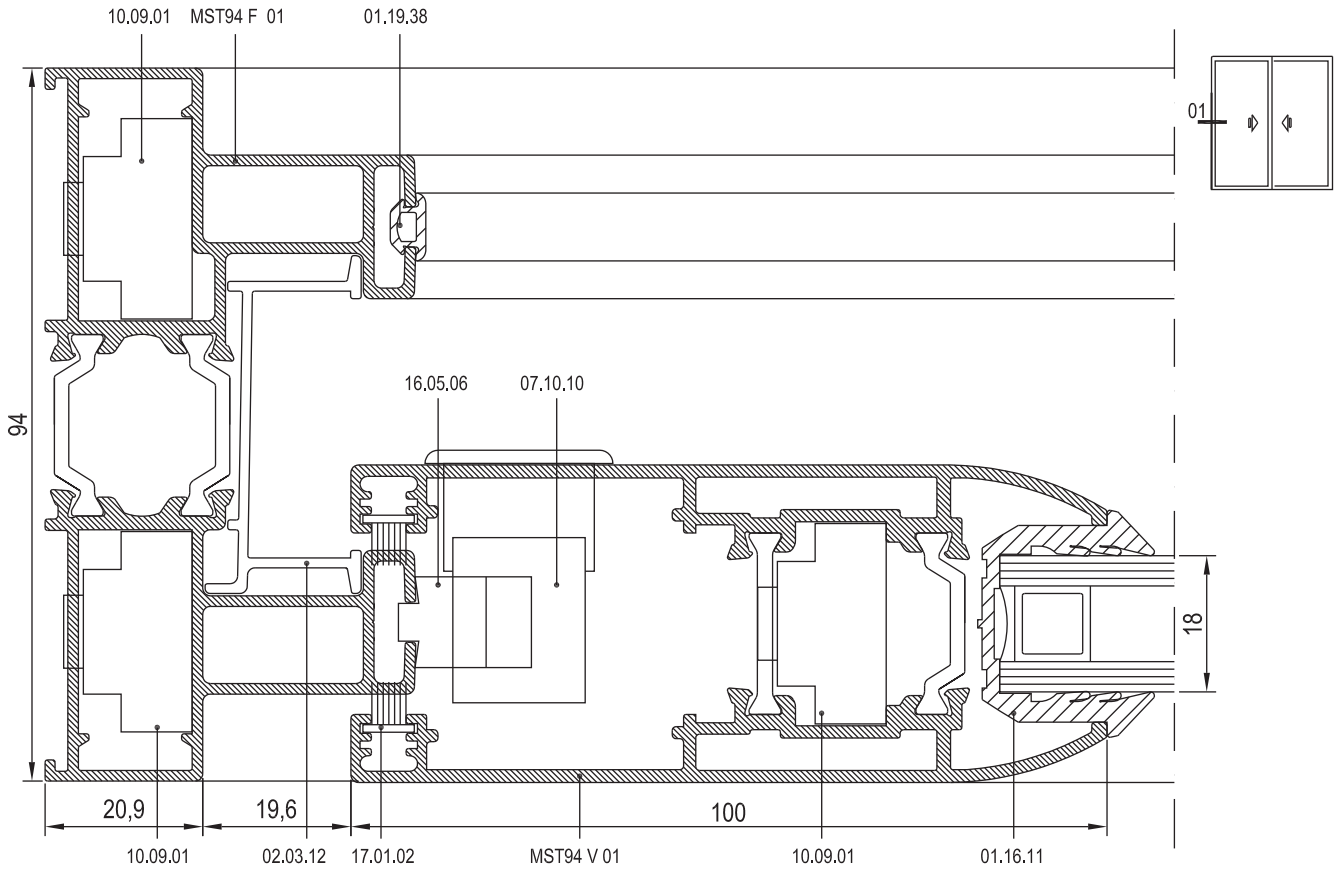

16

17

18

19

20

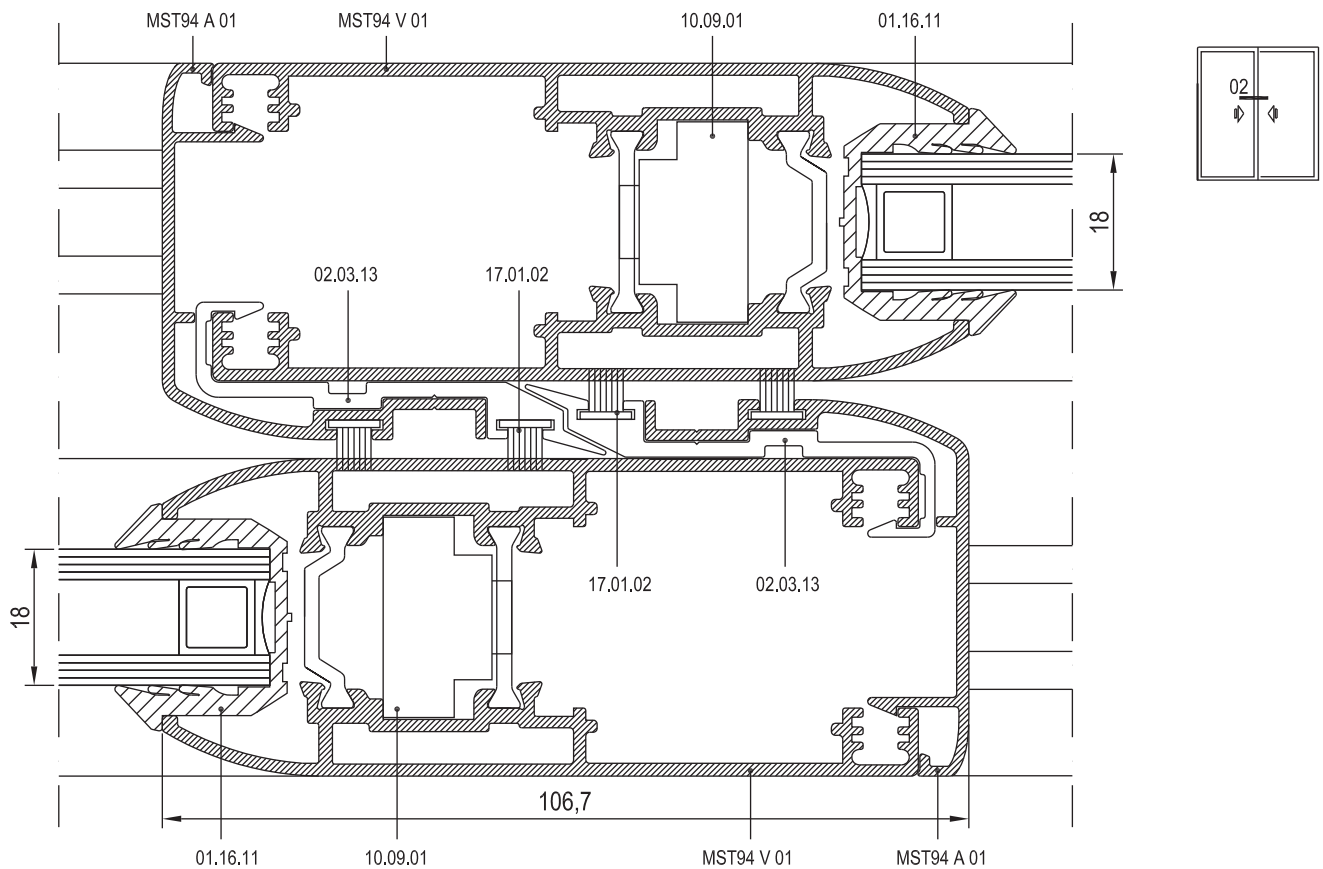

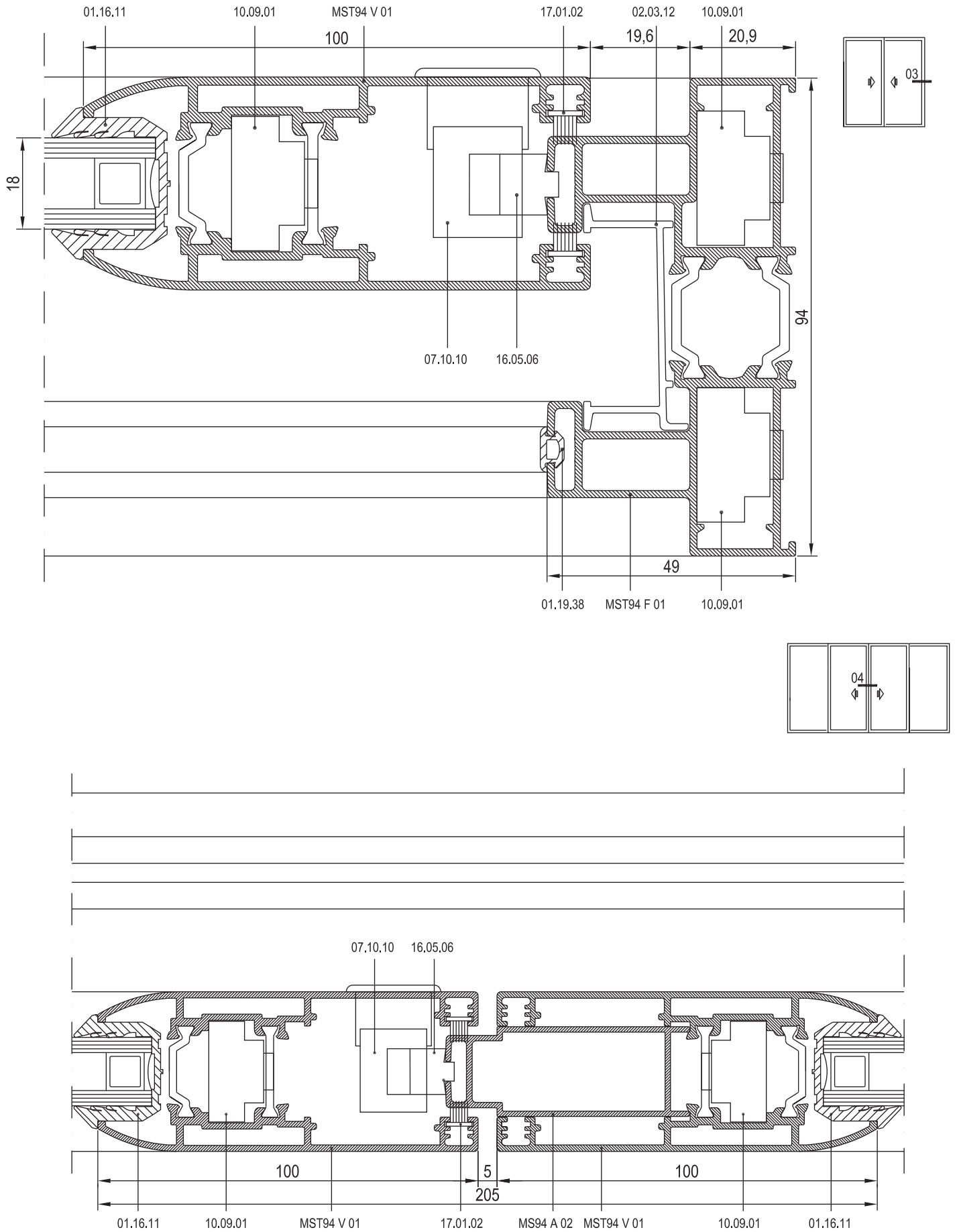

11

12

13

14

15

16

17

18

19

20



11

12

13

14

15

16

17

18

19

20

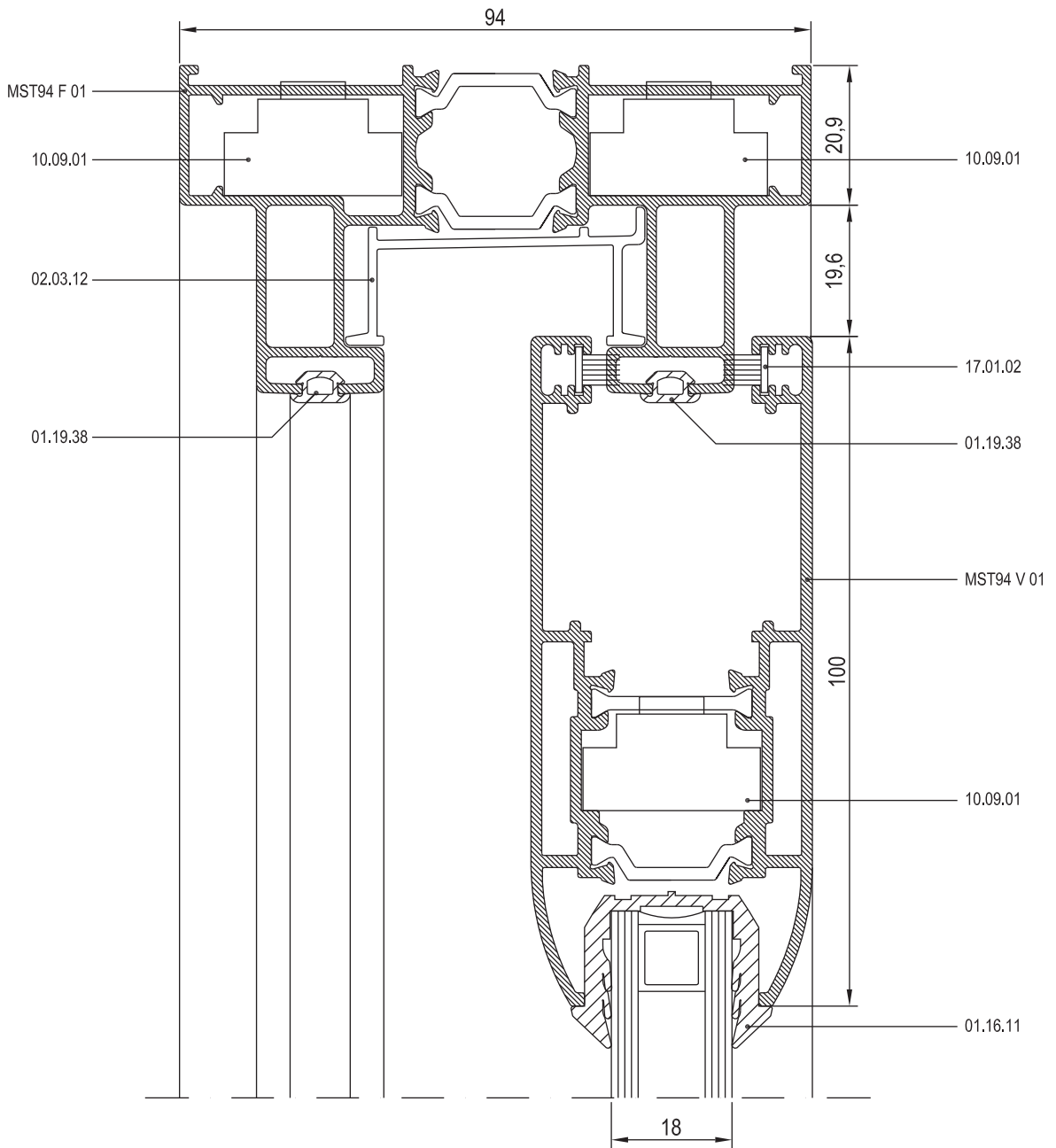
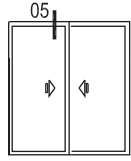



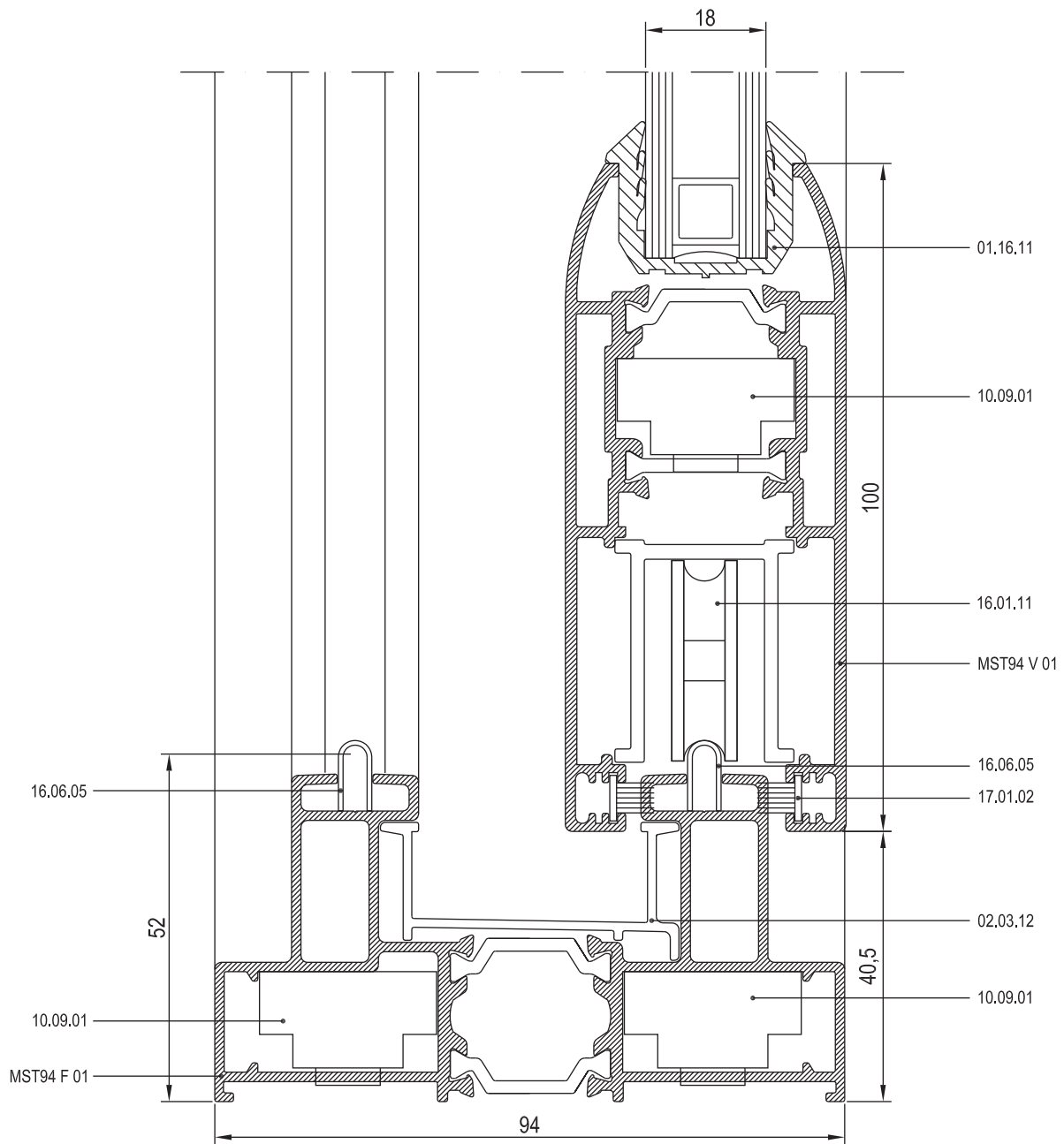
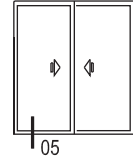

11

12

13

14

15

16

17

18

19

20



11

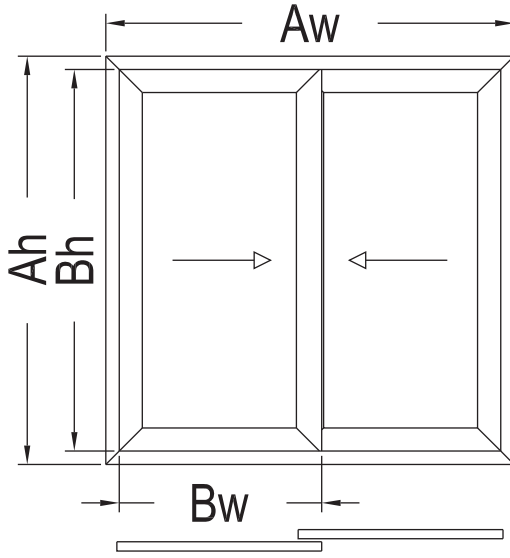

12

13

14

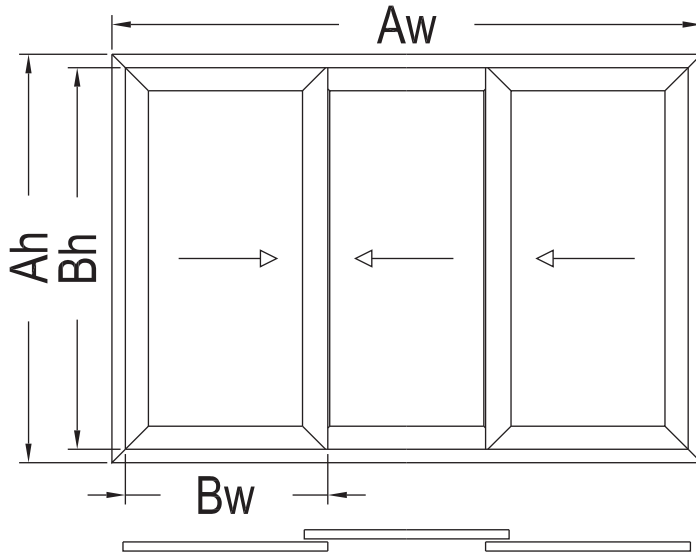

15

16

## PROFİLLER

KOD	PROFİL ÇİZİMİ	ADET	KESİM ÖLÇÜSÜ (mm)
MST94 F 01	A	2	$A_w$
		2	$A_h$
MST94 V 01	B	4	$B_w = \frac{A_w}{2} + 6,2$
		4	$B_h = A_h - 80,9$
MST94 A 01	T	2	$T = B_h$

CAM GENİŞLİĞİ	$G_{lw} = B_w - 171,6$	G <sub>lw</sub> x G <sub>lh</sub> (m <sup>2</sup> )	2 Adet
CAM YÜKSEKLİĞİ	$G_{lh} = B_h - 171,6$		

17

## PROFİLLER

KOD	PROFİL ÇİZİMİ	ADET	KESİM ÖLÇÜSÜ (mm)
MST94 F 01	A	2	$A_w$
		2	$A_h$
MST94 V 01	B	6	$B_w = \frac{A_w}{3} + 35,3$
		6	$B_h = A_h - 80,9$
MST94 A 01	T	4	$T = B_h$

CAM GENİŞLİĞİ	$G_{lw} = B_w - 171,6$	G <sub>lw</sub> x G <sub>lh</sub> (m <sup>2</sup> )	3 Adet
CAM YÜKSEKLİĞİ	$G_{lh} = B_h - 171,6$		

18

## PROFİLLER

KOD	PROFİL ÇİZİMİ	ADET	KESİM ÖLÇÜSÜ (mm)
MST94 F 01	A	2	$A_w$
		2	$A_h$
MST94 V 01	B	8	$B_w = \frac{A_w}{4} + 25,2$
		8	$B_h = A_h - 80,9$
MST94 A 01	T1	4	$T_1 = B_h$
MS94 A 02	T2	1	$T_2 = A_h - 110$

CAM GENİŞLİĞİ	$G_{lw} = B_w - 171,6$	G <sub>lw</sub> x G <sub>lh</sub> (m <sup>2</sup> )	4 Adet
CAM YÜKSEKLİĞİ	$G_{lh} = B_h - 171,6$		

19

20

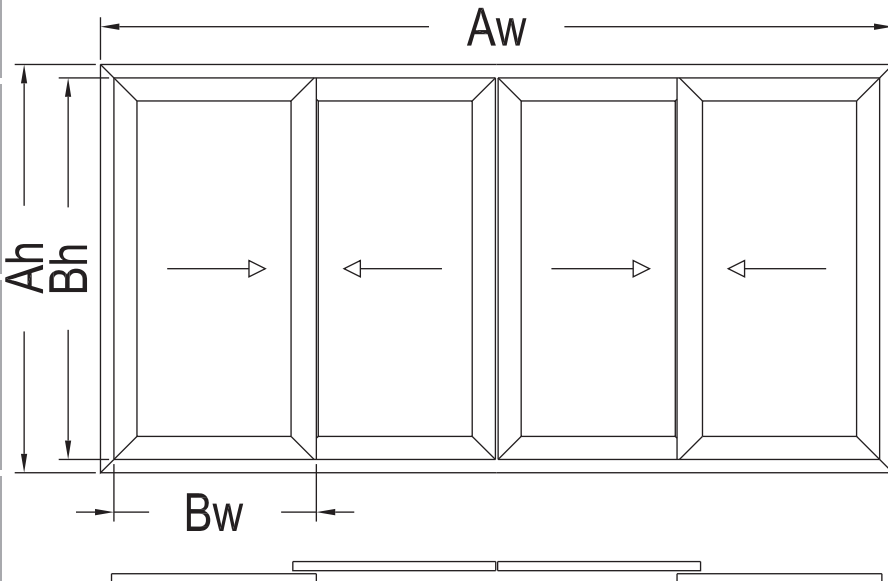



	<p><b>01.16.11</b> CAM FİTİLİ GLAZING GASKET EPDM 232 gr/m</p>			<p><b>07.10.10</b> SÜRME KİLİT SLIDING LOCK</p>	
	<p><b>01.16.12</b> CAM FİTİLİ GLAZING GASKET EPDM 332 gr/m</p>			<p><b>10.04.12</b> KÖŞE ÇAVUŞU CORNER CONNECTION PART PASLANMAZ ÇELİK STAINLESS STEEL</p>	
	<p><b>01.19.38</b> RAY FİTİLİ RAIL CHANNEL GASKET EPDM 27 gr/m</p>			<p><b>10.09.01</b> KÖŞE BAĞLANTI CORNER CONNECTION PIECE</p>	
	<p><b>02.03.12</b> PVC ADAPTÖR PROFİLİ PVC ADAPTER PROFILE</p>			<p><b>11.05.03</b> SABİTLEME TAKOZU PVC SUPPORT</p>	
	<p><b>02.03.13</b> PVC ADAPTÖR PROFİLİ PVC ADAPTER PROFILE</p>			<p><b>16.01.10</b> TEKLİ RULMAN SINGLE BEARING</p>	
	<p><b>04.10.20</b> RAY KAPAĞI ADAPTER CAP PVC</p>			<p><b>16.01.11</b> ÇİFTLİ RULMAN DOUBLE BEARING</p>	
	<p><b>04.11.07</b> SIZDIRMAZLIK PARÇASI SEALING PART EPDM</p>			<p><b>16.05.06</b> SÜRME KİLİT KARŞILIĞI NIB FOR SLIDING LOCK</p>	

11

12

13

14

15

16

17

18

19

20



11

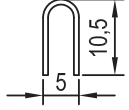

16.06.05

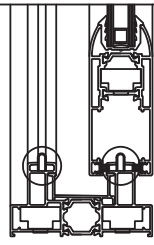
ÇELİK RAY  
STEEL RAIL

12

13

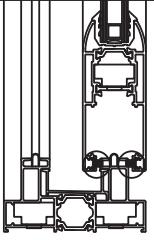

17.01.02

KİL FİTİL  
BRUSH

14

15

16

17

18

19

20

# RESCARA SİSTEM

## RESCARA SYSTEM

Aluminyum Kapı Pencere ve Giydirme Cephe Sistemleri  
Aluminium Window Doors and Facade Systems



11

12

13

14

15

16

17

18

19

20

# RESCARA SİSTEM

## RESCARA SYSTEM

Aluminyum Kapı Pencere ve Giydirmce Cephe Sistemleri  
Aluminium Window Doors and Facade Systems

11



12

13

14

15

16

17

18

19

20